

# W5549 - (5 3/4" - 231)

## Product specification

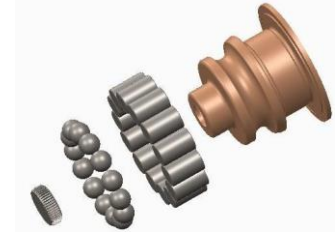
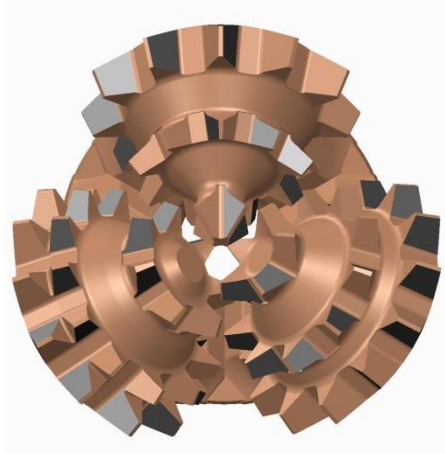

### Product Features

- Conventional gage teeth
- Steel tooth standard open bearing bit for medium hard and moderately abrasive formations

### Product Specifications

Size / Type	5 3/4" & CN23	Cutting structure	ST
IADC	2-3-1	Rows	3- Gage & 6 – inner
Pin Connection	3 1/2 API REG	Teeth count	36– Gage & 57- Inner
Bearing	Ball Roller Friction	Teeth Type	Straight
Circulation type	Centre Flush	Gage Protection	Hard facing
Product weight	11.8kg	Shirttail protection	2/3 <sup>rd</sup> Hard facing
Nozzle	-NA-	Shirttail insert	Spherical

### Operating parameters

- Weight on Bit : 17,000 - 28,500 lbs.  
 Rotary Speed (RPM) : 60 –100 RPM  
 Rock UCS : Between 4,000 to 9,000 PSI

*Operating parameters are typical ranges and may vary depending on ground conditions*