

# W5547 - (5 3/4" - 111)

## Product specification

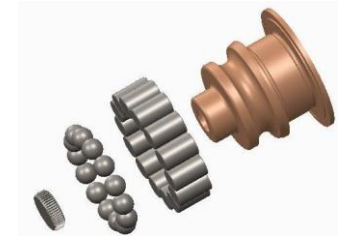
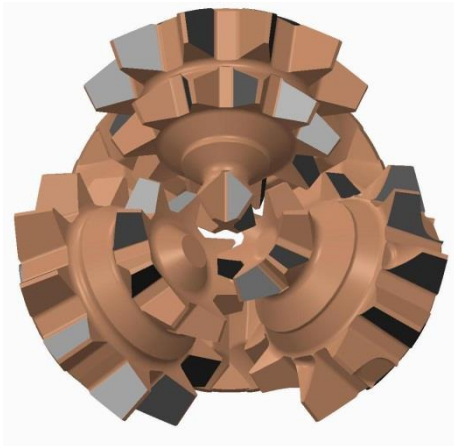

### Product Features

- Conventional gage teeth
- Steel tooth standard open bearing bit for medium hard and moderately abrasive formations

### Product Specifications

Size / Type	5 3/4" & CN11	Cutting structure	ST
IADC	1-1-1	Rows	3- Gage & 4 – inner
Pin Connection	3 1/2 API REG	Teeth count	31– Gage & 28- Inner
Bearing	Roller Ball Friction	Teeth Type	Straight
Circulation type	Centre Flush	Gage Protection	Hard facing
Product weight	11.8 kg	Shirttail protection	2/3 <sup>rd</sup> Hard facing
Nozzle	-NA-	Shirttail insert	Spherical

### Operating parameters

Weight on Bit : 5,700 – 17,000 lbs.  
 Rotary Speed (RPM) : 70 –120 RPM  
 Rock UCS : Between 1,000 to 4,000 PSI

*Operating parameters are typical ranges and may vary depending on ground conditions*

Rev:00

Date: 07/03/2013

Approved By : kv