

# 6 3/4" (3-2-1) (W5744)

## Product specification

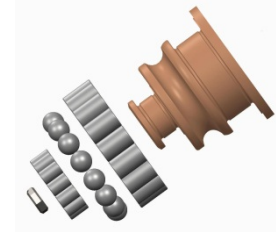
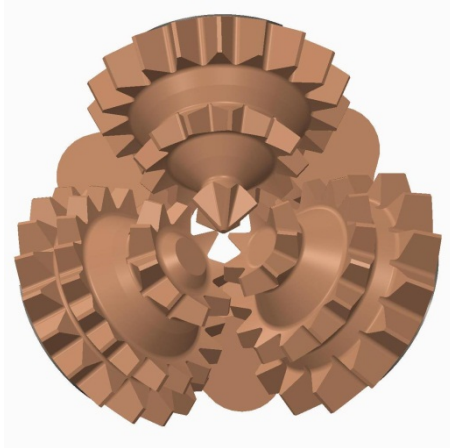

### Product Features

- Conventional gage teeth
- 2/3<sup>rd</sup> Steel tooth standard open bearing bit for medium hard and moderately abrasive formations

### Product Specifications

Size / Type	6 3/4"	Cutting structure	ST
IADC	3-2-1	Rows	3- Gage / 5 – inner
Pin Connection	3 1/2" API Regular	Teeth count	50– Gage / 65- Inner
Bearing	Ball Roller Friction	Teeth Type	Straight
Circulation type	Centre Flush	Gage Protection	Hard facing
Product weight	16kg	Shirttail protection	2/3 <sup>rd</sup> Hard facing
Nozzle	-NA-	Shirttail insert	Serrated

### Operating parameters

Weight on Bit : 27,000 - 47,000 lbs.  
 Rotary Speed (RPM) : 60 – 80 RPM  
 Rock UCS : Between 10,000 to 22,500 PSI

*Operating parameters are typical ranges and may vary depending on ground conditions*