

6 3/4" (2-3-1) (W5741)

Product specification

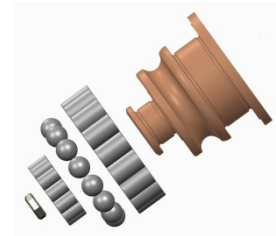
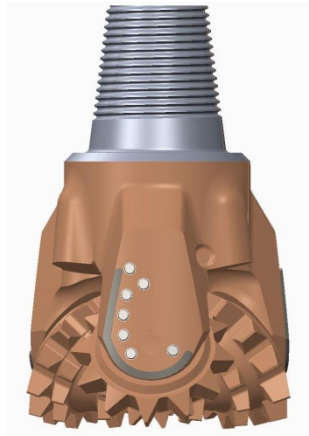
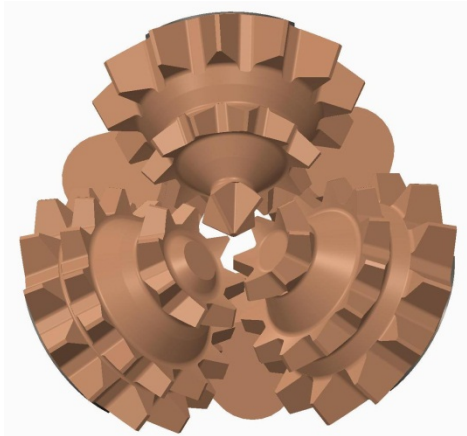

Product Features

- Conventional gage teeth
- 2/3rd shirrtail protection for soft to medium hard and moderately abrasive formations

Product Specifications

Size / Type	6 3/4"	Cutting structure	ST
IADC	2-3-1	Rows	3- Gage / 5 – inner
Pin Connection	3 1/2" API Regular	Teeth count	37– Gage / 40- Inner
Bearing	Roller Ball Friction	Teeth Type	Straight
Circulation type	Centre Flush	Gage Protection	Hard facing
Product weight	16 kg	Shirrtail protection	2/3 rd Hard facing
Nozzle	-NA-	Shirrtail insert	Serrated

Operating parameters

Weight on Bit : 20,000 – 33,500 lbs.
 Rotary Speed (RPM) : 60 –100 RPM
 Rock UCS : Between 2,500 to10,000 PSI

Operating parameters are typical ranges and may vary depending on ground conditions