

# 6" (1-1-1) (W5619)

## Product specification

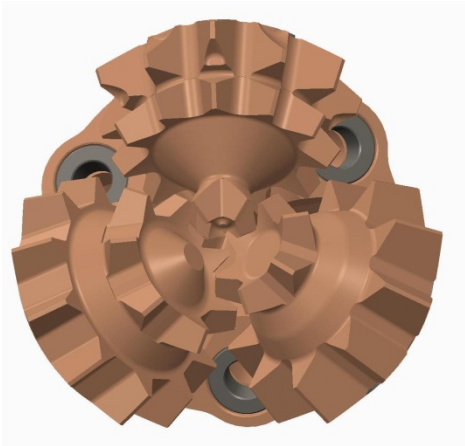

### Product Features

- Conventional gage teeth
- 2/3<sup>rd</sup> shirrtail protection for soft and moderately abrasive formations

### Product Specifications

Size / Type	6"	Cutting structure	ST
IADC	1-1-1	Rows	3- Gage / 4 – inner
Pin Connection	3 1/2" API Regular	Teeth count	32– Gage / 28- Inner
Bearing	Roller Ball Friction	Teeth Type	Straight
Circulation type	Centre Flush	Gage Protection	Hard facing
Product weight	12.5 kg	Shirrtail protection	2/3 <sup>rd</sup> Hard facing
Nozzle	-NA-	Shirrtail insert	Serrated

### Operating parameters

Weight on Bit : 6,000 – 18,000 lbs.  
 Rotary Speed (RPM) : 70 –120 RPM  
 Rock UCS : Between 2,500 to7,500 PSI

*Operating parameters are typical ranges and may vary depending on ground conditions*