

3 7/8" (5-2-1) (W5218)

Product specification

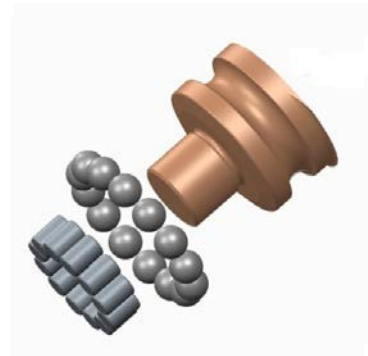
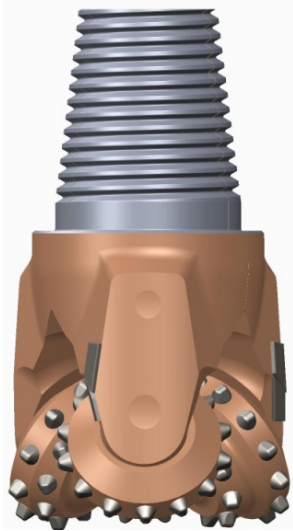
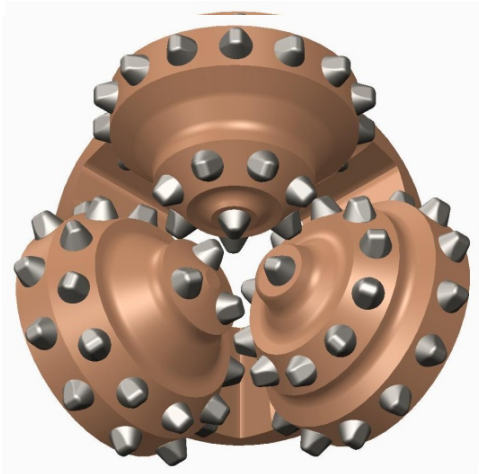

Product Features

- Chisel buttons on Gage
- Standard open bearing bit for soft to medium hard formations and moderately abrasive formations.

Product Specifications

Size / Type	3 7/8"	Cutting structure	TC
IADC	5-2-1	Rows	3- Gage / 6 – inner
Pin Connection	2 3/8" API Regular	Inserts count	38– Gage / 33- Inner
Bearing	Ball Roller Friction	Gage inserts	Chisel
Circulation type	Centre Flush	Inner inserts	Chisel
Product weight	4kg	Gage Protection	Hard facing
Nozzle	-NA-	Shirrtail protection	---

Operating parameters

Weight on Bit : 11,500 - 25,000 lbs
 Rotary Speed (RPM) : 50 – 150 RPM
 Rock UCS : Between 10,000 to 22,500 PSI

Operating parameters are typical ranges and may vary depending on ground conditions