

7 7/8" (1-1-7) – S4053

Product specification

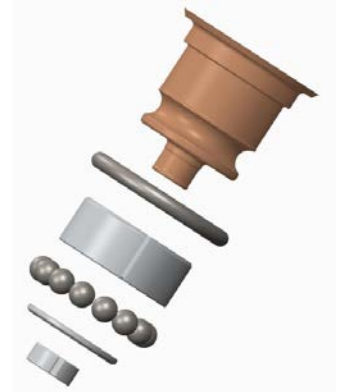
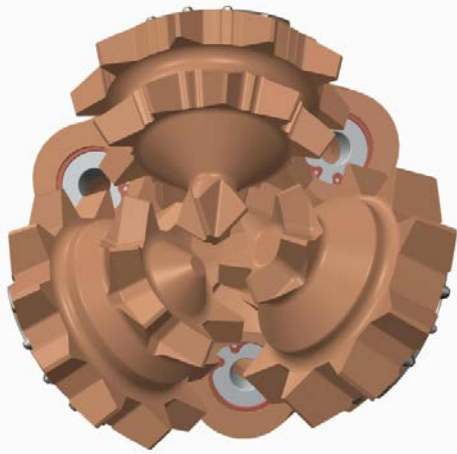

Product Features

- Aggressive cutting structure with high offset bearing design.
- Full cap hard facing on teeth for durability.
- Side Jet Nozzles of optional size, to handle mud circulation.
- Shirrtail lip protection with wear resistant hard facing.
- 2/3rd shirrtail protection for soft and moderately abrasive formations

Product Specifications

Size / Type	7 7/8"	Cutting structure	ST
IADC	1-1-7	Rows	03 - Gage / 04 – Inner
Pin Connection	4 1/2" API Regular	Teeth count	29 - Gage /25 – Inner
Bearing	Sealed journal	Teeth type	Straight
Circulation type	Jet	Gage Protection	TC Inserts Chisel
Product weight	27 kg	Shirrtail protection	Full h/f , 2/3 rd Tc inserts
Nozzle	3 x Side jet	Shirrtail insert	Spherical

Operating parameters

Weight on Bit : 7,500 – 23,500lbs
 Rotary Speed (RPM) : 70 - 120
 Rock UCS : Between 25,00 to 7,500 PSI

Operating parameters are typical ranges and may vary depending on ground conditions