

Product specification

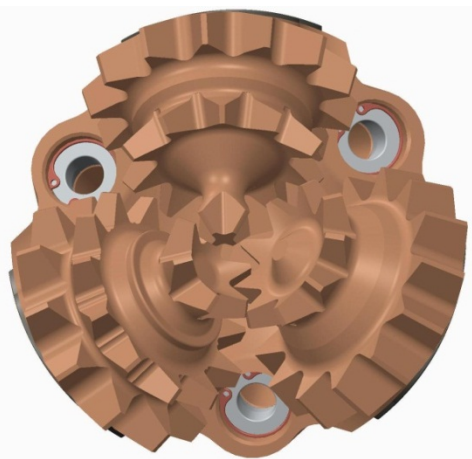

Product Features

- Aggressive cutting structure with medium offset bearing design
- Full cap hard facing on teeth for durability.
- Side Jet Nozzles of optional size, to handle mud circulation.
- Shirrtail lip protection with wear resistant hard facing.
- Full shirrtail protection for soft and moderately abrasive formations

Product Specifications

Size / Type	618"	Cutting structure	ST
IADC	2-1-4	Rows	03 - Gage / 05 – Inner
Pin Connection	3 1/2" API Regular	Teeth count	39- Gage /41 – Inner
Bearing	Sealed Journal	Teeth type	Straight
Circulation type	Jet	Gage Protection	Hard facing
Product weight	18 kg	Shirrtail protection	Full hard facing
Nozzle	3 x Side jet	Shirrtail insert	

Operating parameters

Weight on Bit : 18,000 – 30,500 lbs
 Rotary Speed (RPM) : 60 -100
 Rock UCS : Between 2,500 to 10000 PSI

Operating parameters are typical ranges and may vary depending on ground conditions